

ELECTRIC DRUM PUMP

FP-25 OPERATION MANUAL

- Please read carefully before use and understand how to operate. Wrong usage may cause accident or injury.
- Please keep this manual for future reference.

SAFETY CAUTION

Read this "SAFETY CAUTION" carefully before use. These following cautions are for correct usage of product and prevent you or others from injury or harm.

Each article contains important contents. Following are the articles:

- ⚠ DANGER** : may cause death or serious injury on high level.
- ⚠ WARNING** : may cause death or serious injury.
- ⚠ CAUTION** : may cause serious injury or major damage.

It is necessary to follow the article.

KOSHIN LTD.

www.koshinpump.com

TEL.: +81-75-953-2499 FAX.: +81-75-954-6119
E-mail: info@koshin-ltd.co.jp
12 Kami-Hachinotsubo Kotari, Nagaokakyo City,
Kyoto 617-8511 JAPAN

22-03 004034204

⚠ CAUTION



Do not harm, damage, twist or break electric cable. Do not put heavy objects on the cable. This may cause damage to the cable and may cause fire, electric shock.



Do not use this product if electric cable or electric plug is damaged or inadequate connection with power supply. It may cause electric shock, short-circuit or fire.



Besides rated voltage, do not use this product. It may cause fire, electric-shock. Please do not allow too many wiring from one socket. It may cause overheat or cause voltage power to be reduced.



Do not dismantle the product. It may cause electric-shock or injury.



Do not give any shock to the product during operation. It might cause fire by electric-shock, short-circuit or electric leakage.



If the product does not operate or looks like an abnormal run, take off electric cable immediately from socket, and ask for checking or repair with your local distributor/dealers.



Please do not run dry. (Operation without liquid in drum) It may cause damage to the product.

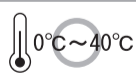

Use this product with liquid temperature between 0-40 degrees centigrade.



In case of extension power cord, please use cable with more than 1.25 mm² (for 15 A) and use only necessary length. If thin or long power cord is used, it may lead to inferior performance or even damage the product.



When lifting the product, please do not pull power cord or hose. It may damage the power cord or hose.

* All these important safety instructions described by this operation manual may not cover all the conditions and cases of usage. We pay careful attention about safety of the product. Please pay careful attention by user, operator, technician for maintenance as well.

⚠ DANGER



This product is for kerosene or diesel application only. This product cannot be used for petroleum grade liquid, such as gasoline, A-crude, solvents, Chemicals, water. (danger - may cause explosion, fire, or damage)



This product does not use flame-proof motor.



Do not use this product near inflammable objects such as petrol.



Do not use fire when you operate this product. It may cause fire.

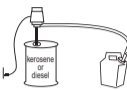

This product is exclusively designed for transfer of kerosene or diesel only. Do not use for other applications.

⚠ WARNING



Do not leave the pump unattended during operation.



Do not operate this product without understanding the operation manual.



Operate this product in a safe place away from children.



Besides trained technician of repair, do not dismantle, repair, rebuild. It may cause damage.



Do not wet the product with water or oil. It may cause serious accident, injury, or damage to the product due to electric shock, short-circuit, or electric leakage.



Please do not use outdoor. This product may be damaged if wet by rain or water.

THE NAME OF PARTS

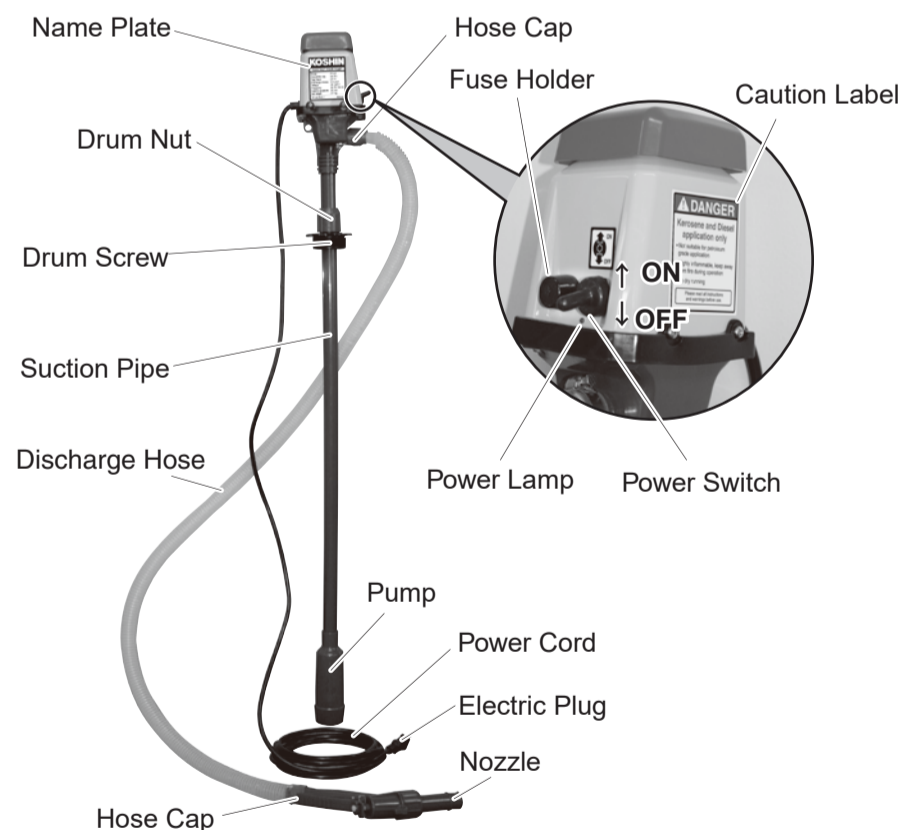

SPECIFICATIONS

Model	FP-25
Type	FP-25-BAA
Connection dia	25 mm (1")
Total head	3.5 m
Discharge volume	20 L/min
Voltage	AC 220 V 50 / 60 Hz
Continuous operating time	30 min
Power cord	4 m
Fuse	4 A
Discharge hose	1.5 m
Nozze	Gun type
Net weight	2.7 kg

※ We offer 1.5 m discharge hose as option item. 1.5 m discharge hose is replacement type.

HOW TO USE

1. Insert suction pipe into Drum.
Fix Drum screw onto the collar.
Turn Drum Nut to fix.

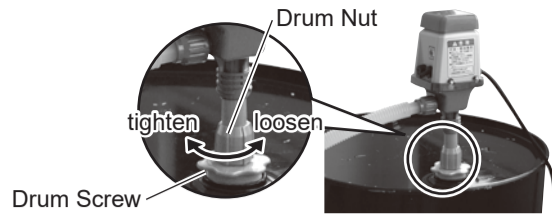

CAUTION After fixing the pump to the drum, please do not operate pump or drum at oblique condition.

CAUTION When you loosen "Drum Nut", hold the pump body by another hand. Otherwise, pump body may drop suddenly and cause injury or damage.

2. Make sure Power Switch is "OFF" and Lever Lock of Nozzle is released, then, connect power plug.

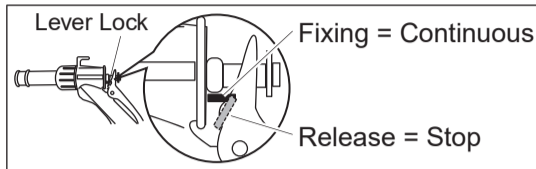

3. Put Power Switch "ON" and grip the Lever of Nozzle.

4. If you use Lever Lock, pump will transfer oil continuously.
Release lever lock when stop continuous operation.

DANGER Do not be near fire during operation

DANGER If do not release the lever lock, the outflow of oil does not stop. To avoid a oil overflow, please operate carefully

PROHIBITED When Power Switch is "ON" and motor is running, please do not leave pump with Lever Lock for more than 3 minutes. (It might cause damage or accident.)

CAUTION AFTER USE

1. After using pump, switch power to "OFF". Release Lever Lock of Nozzle, then, remove electric plug from socket.
2. Remove pump from the drum. Remove oil in the suction pipe, hose, and nozzle. Wipe off excess oil on the surface of the pump with a duster.

CAUTION After use, do not put pump on the ground directly. If dust gather at the strainer, it may cause future inferior suction or damage.

TROUBLE SHOOTING AND MAINTENANCE

CAUTION Please do not dismantle or repair the pump by yourself. Please ask for repair work from your local distributor /dealers.

Condition	Possible Cause	Measure
No discharge (No suction) Pump does not work	Dirt & dust inside pump	Open pump and clean
	Burn out Fuse *In such case, power lamp is light "ON"	Take corrective action for the cause of the blown fuse and replace the fuse. (Refer to MAINTENANCE · CHECK)
	Voltage drop when using extension cord	Reduce extension cord length
	Motor does not work	Ask repair by local distributor / dealer
	Disconnection of power cord (Check power lamp is light "ON" or not.)	
Electric plug does not sit well into the socket (Check power lamp is light "ON" or not.)	Check electric plug and socket.	
No discharge (No suction) or, small discharge volume - pump is working.	Air-Lock inside pump	Turn power switch to "Off" and re-start A
	Hose is too long (in case of extension)	Shorten the hose.
	No liquid, not enough flow In the drum	Fill liquid into the drum
	Strainer is clogged with dust	Cleaning
	Bending hose	Straighten hose
Oil leakage	Sealing failure of packing caused by screw loosening.	Tighten screw
Oil leakage from connection part of hose	Hose cap is not tightened enough	Tighten hose cap firmly
Oil leakage from nozzle	Leakage due to Siphon phenomenon	Remove liquid inside hose and keep position of hose higher than the pump before storage B

3. Storage

Please keep pump clean, in low humidity, well-ventilated, indoor, away from sunlight.

CAUTION Please lay down the pump during storage to avoid inversion.

4. Clean Strainer if you do not use this pump for long time. (Refer Maintenance, Check)

CAUTION If position of nozzle is lower than liquid level in the drum, liquid may leak from nozzle due to Siphon phenomenon. Put out this pump from drum before storage.

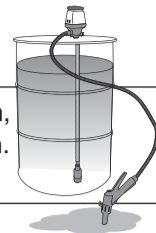

MAINTENANCE · CHECK

CAUTION During maintenance and check, always turn switch to "OFF" and remove electric plug from socket. Otherwise may cause accident or injury.

[Cleaning of Strainer · Impeller]

If dust obstruct Strainer or Impeller, it may cause inferior suction, inferior flow, shorten pump's life and damage of motor. Make sure electric plug is removed from socket and check following points regularly.

1. Remove Strainer by turning towards indicated direction, remove all dirt and dust.
2. Remove Casing and clean up dust inside the Impeller.
3. After cleaning, re-assemble by reverse course.

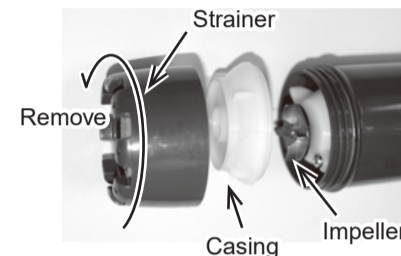

[Replacement of Fuse]

A fuse may burn out to protect motor damage if surplus current enters the motor. It is necessary to replace a fuse in this case.

1. Remove fuse cover by + screw driver, turn counterclockwise.
2. Remove fuse, check if it is "burn out" then, replace with new 4 A fuse. **Do not use fuse other than 4A.**
3. Please re-assemble by reverse course.



CAUTION If the fuse blows frequently, the oil seal of the motor may be worn out, and kerosene or light oil may have entered the motor and the fuse may blow due to overload. Please ask for repair work from your local distributor / dealers.

- First, put the pump into drum and then, make the switch ON.

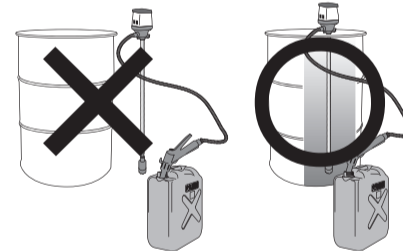

- If position of nozzle is lower than liquid level in the drum, liquid may leak from nozzle due to Siphon phenomenon. Put out this pump from drum before storage.

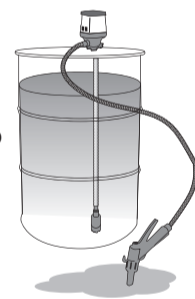

SPARE PARTS



For spare parts information, visit <http://www.koshinpump.com>